

# WHITE LAKE OPEN 2023

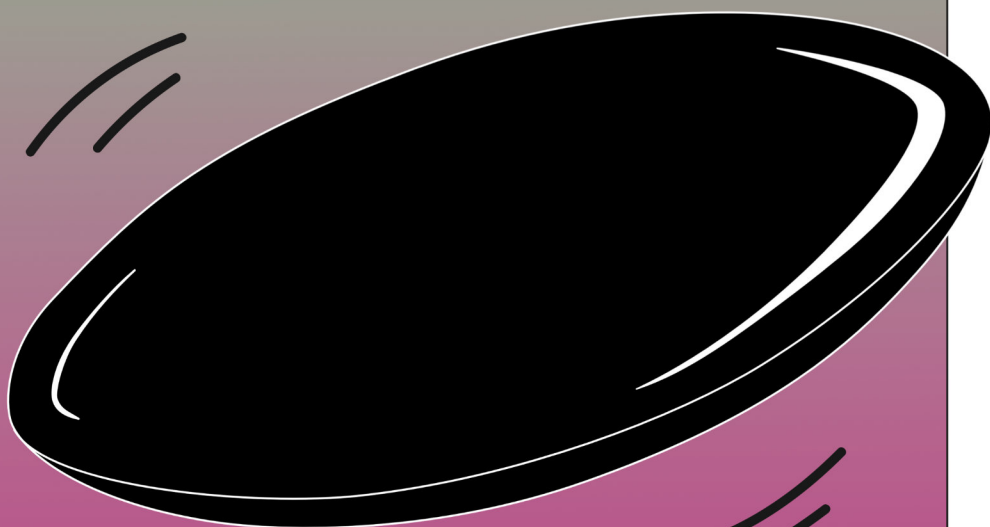

Caddy-Book

18.03.2023

Weißensee Berlin

Willkommen zur ersten Whitelake Open!  
Ein Turnier der Pepper Disc Berlin Community für alle. Als Teil vom Pfeffersport, einem der größten inklusiven Sportvereine in Berlin, soll dieses Turnier so fair und offen sein wie unser Verein.

So entstand bei den Discgolfer\*innen der Sektion die Idee für dieses Event und wurde von einer Gruppe engagierter Mitglieder umgesetzt.

Gleiche Chancen sowie ein möglichst diverses Starterfeld waren das Ziel. Dementsprechend gab es ein Stipendienprogramm und garantierte Startplätze für Frauen und Junioren. Die restlichen Startplätze wurden verlost.

Auch wollten wir unseren Heimatkurs größer denken. Zum ersten Mal werden die Teilnehmer\*innen beim Turnier die Möglichkeit haben, volle 18 Bahnen zu spielen. Vier von diesen haben wir exklusiv für die Whitelake Open entworfen.

Wir wünschen allen Starter\*innen einen großartigen Tag und viel Erfolg.

Euer Turnier-Orga Team

Welcome to the first Whitelake Open! A tournament by the Pepper Disc Berlin community for everyone. As part of Pfeffersport, which is one of the biggest inclusive sport clubs in Berlin, we want this tournament to be as fair and open as our club itself. This was where the idea for this event originated. Then a group of committed members made their idea a reality. The goals were for the same chances for everyone to play, as well as a diverse field of competitors. This is why we implemented a scholarship program and guaranteed spots for women and juniors and why all other spots were raffled. We also had a bigger vision about our home course. For the first time ever participants have the chance to play a full 18 hole layout. Four of those are exclusive for the Whitelake Open. We hope all of you will have a great day and a successful tournament.

Yours sincerely the organizational team

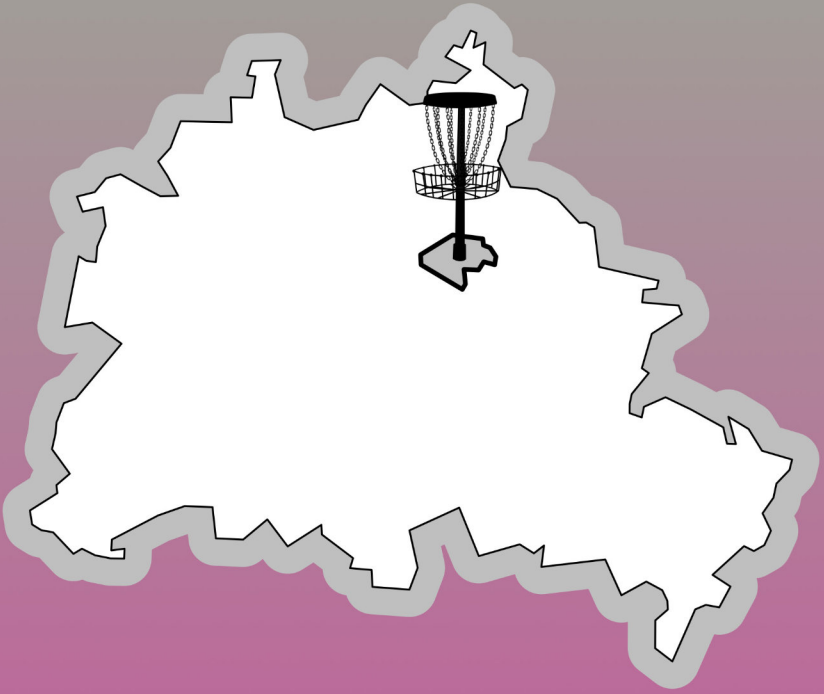



# Whitelake Open 2023 Layout

**Pffersport**

[www.pffersport-discgolf.de](http://www.pffersport-discgolf.de)

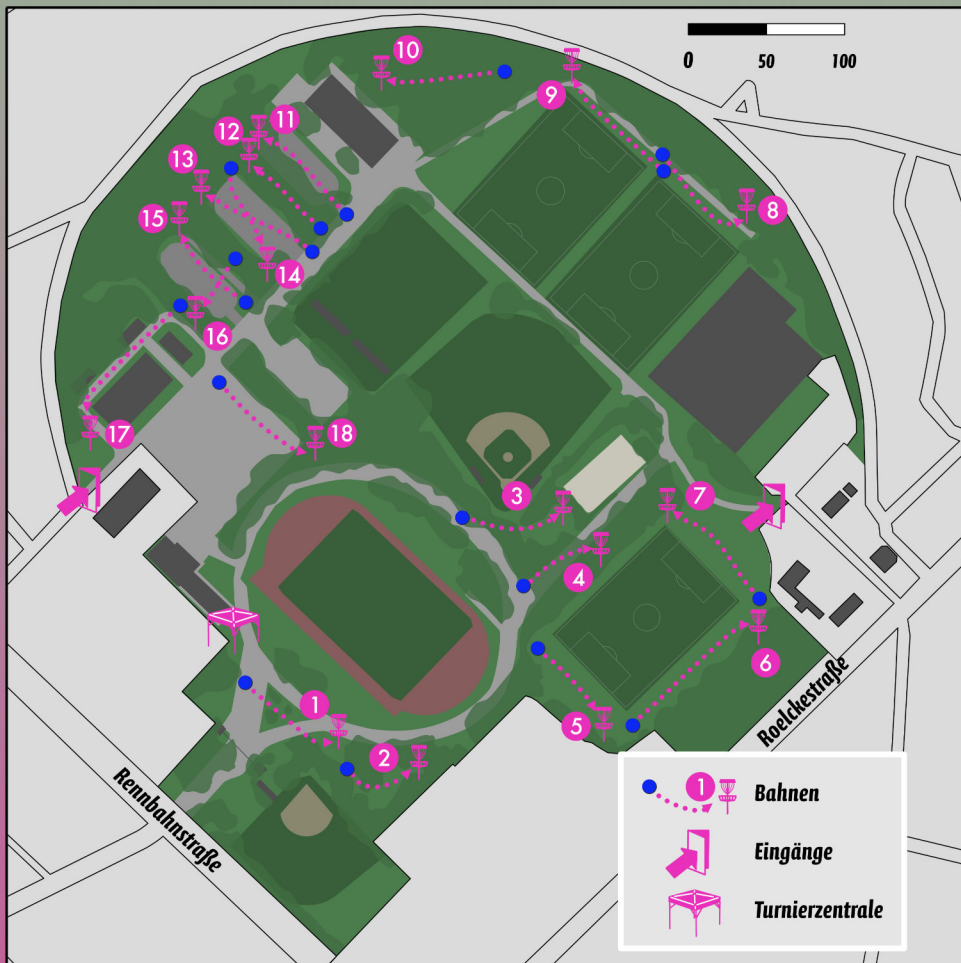

Bahn	1	2	3	4	5	6	7	8	9	10	11	12	13	14	15	16	17	18	Total
Par	3	3	3	3	3	3	3	3	3	3	3	3	3	3	3	3	4	3	55
Länge	80	60	65	55	75	105	90	75	80	75	75	70	80	65	70	50	125	85	1380

# 1

- everything outside the two islands defined on the map is OB, the OB line is either the start of concrete or the outside line of the fence to the soft-ball field
- the mandatory on the second island has to be passed on the right and the mandatory line is perpendicular to the line from tee to basket
- all throws of the tee that either miss the mandatory or land OB proceed to the drop zone on the first island, continue throwing from the drop zone until the disc both passes the mandatory and lands inbounds

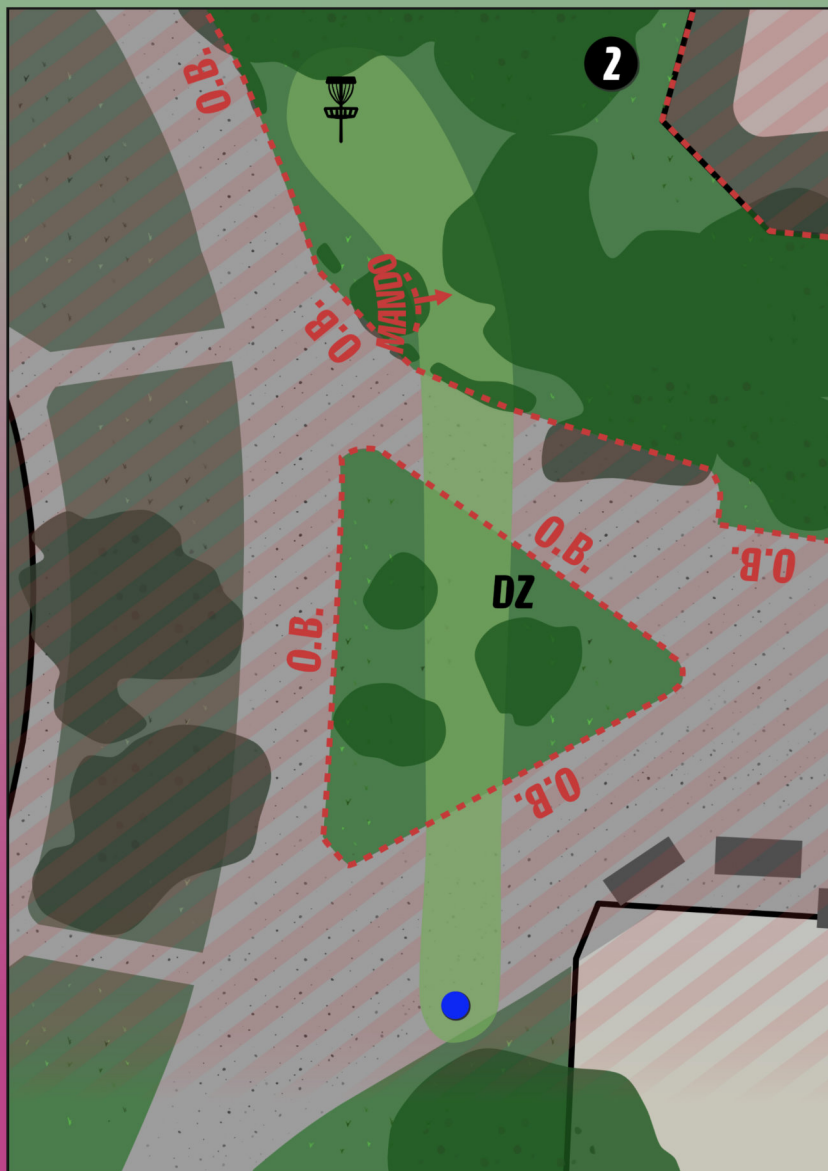

**HOLE 1 • PAR 3 • 80 M**

# 2

- mandatory ahead of tee on the left has to be passed on the right
- mandatory plane is perpendicular to the line between tee and drop zone
- all throws from the tee that miss the mandatory result in the next throw happening from the drop zone
- everything beyond the fence on the right of the fairway is OB



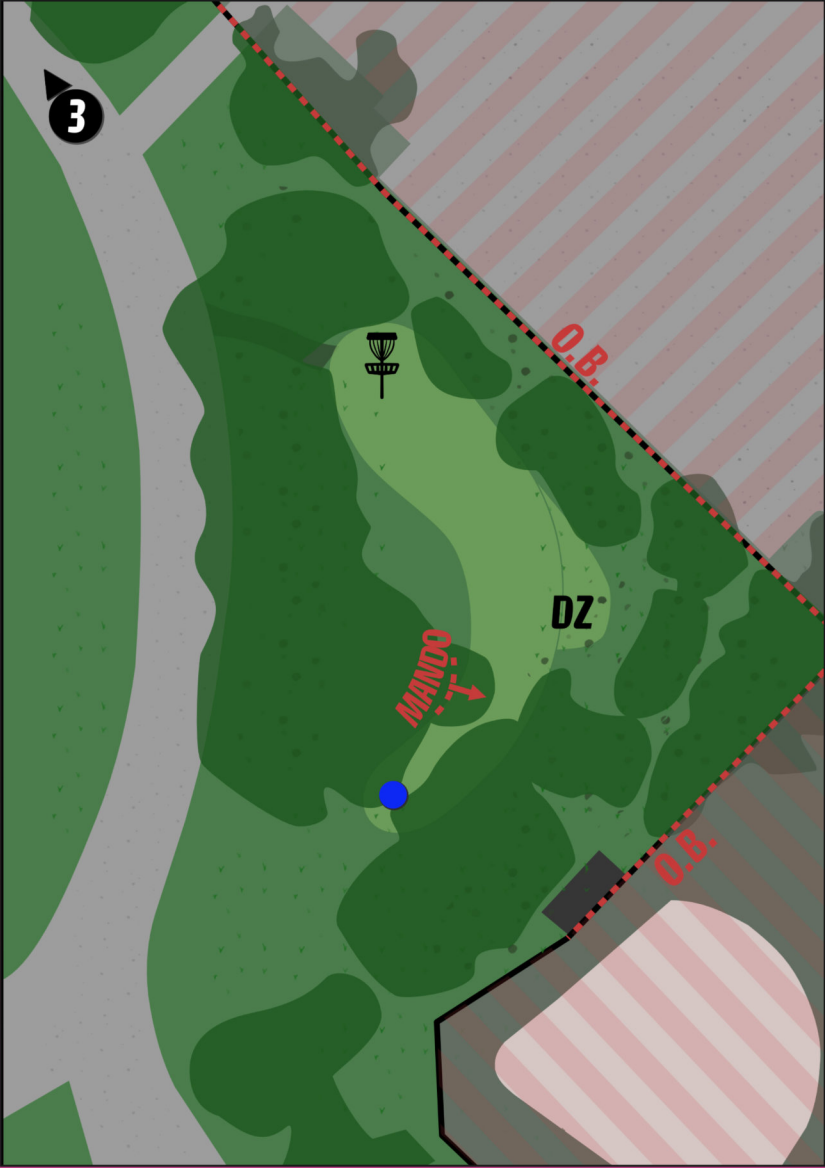

**HOLE 2**  
•  
**PAR 3**  
•  
**60 M**



3

- baseball field to the left is OB as marked by the fence
- beach volleyball area behind the basket is OB as marked by the fence
- watch out for players on the fairway of the following hole 4

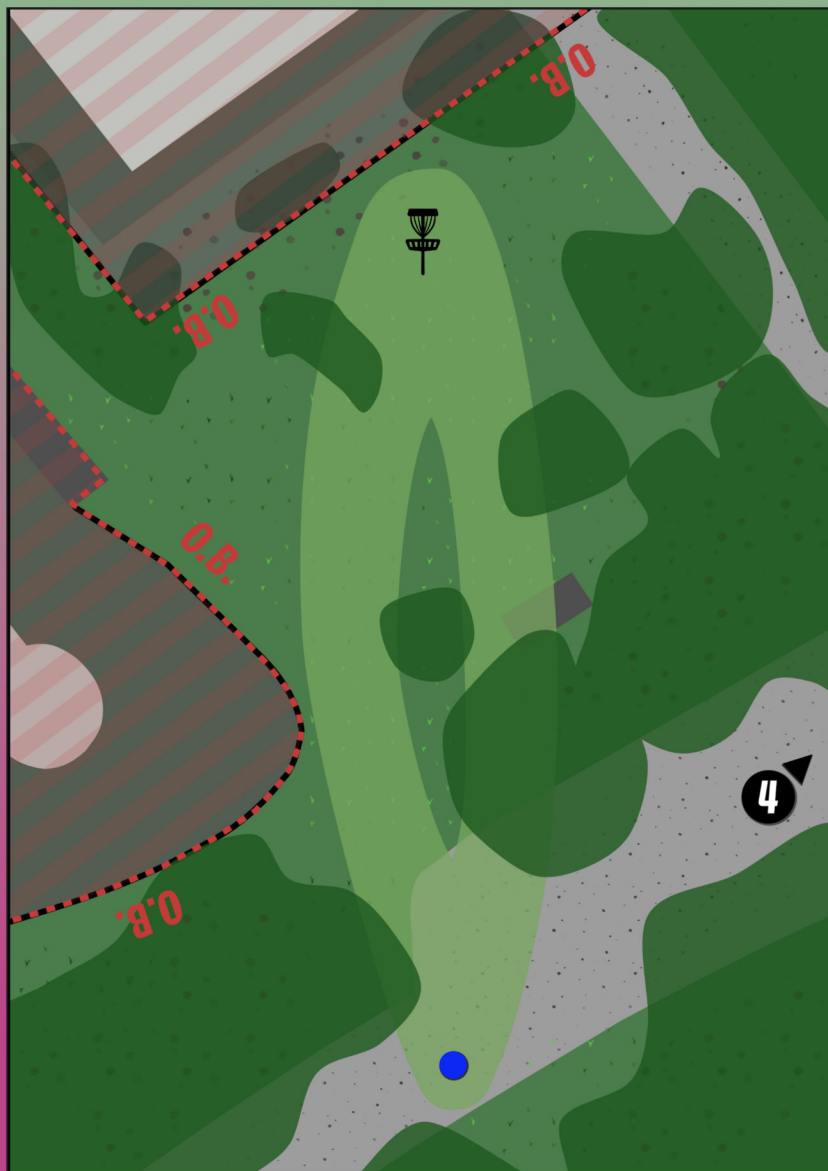

**HOLE**

**3**

•

**PAR**

**3**

•

**65  
M**



4

→ everything past the fence separating the road/fairway from the beach volleyball is OB



**HOLE**  
**4** •  
**PAR**  
**3** •  
**55**  
**M**



5

- the football field is out of bounds as marked
- everything beyond the property line as marked by the fence is out of bounds

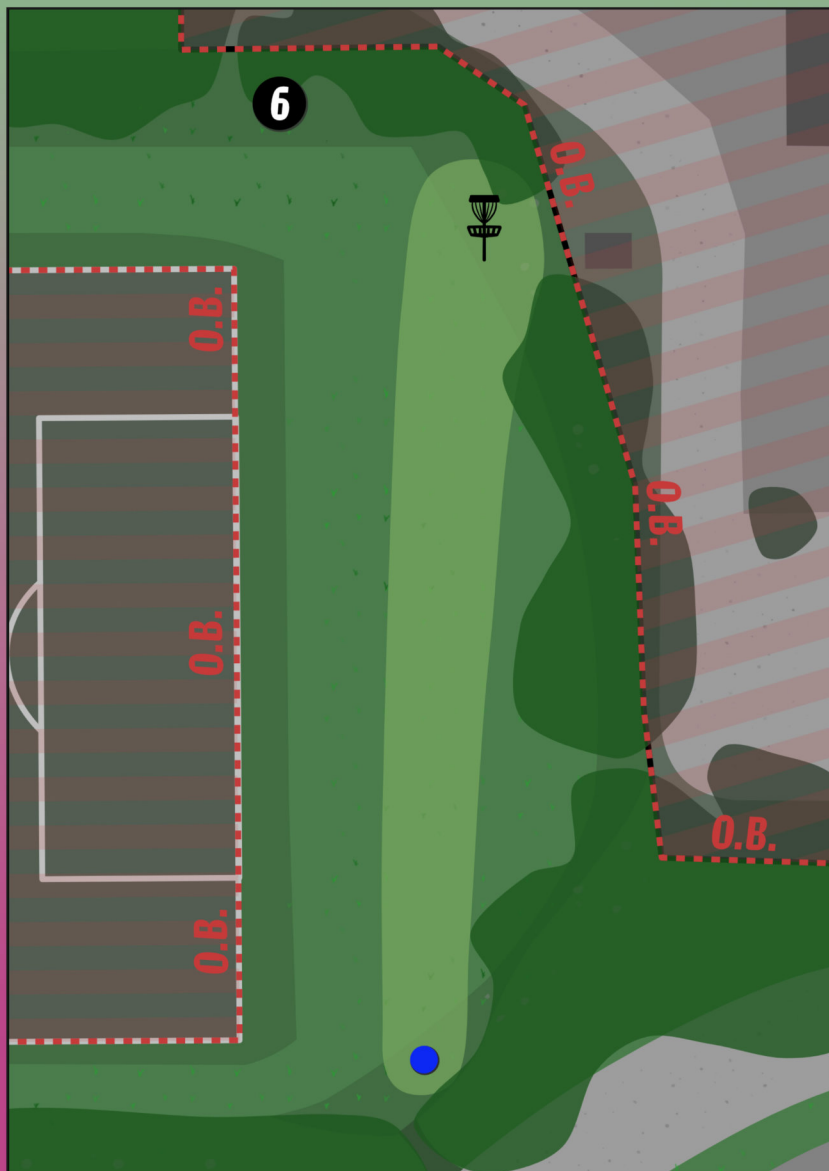

**HOLE**

**5**

•

**PAR**

**3**

•

**75  
M**



6

- the football field is out of bounds as marked
- everything beyond the property line as marked by the fence is out of bounds



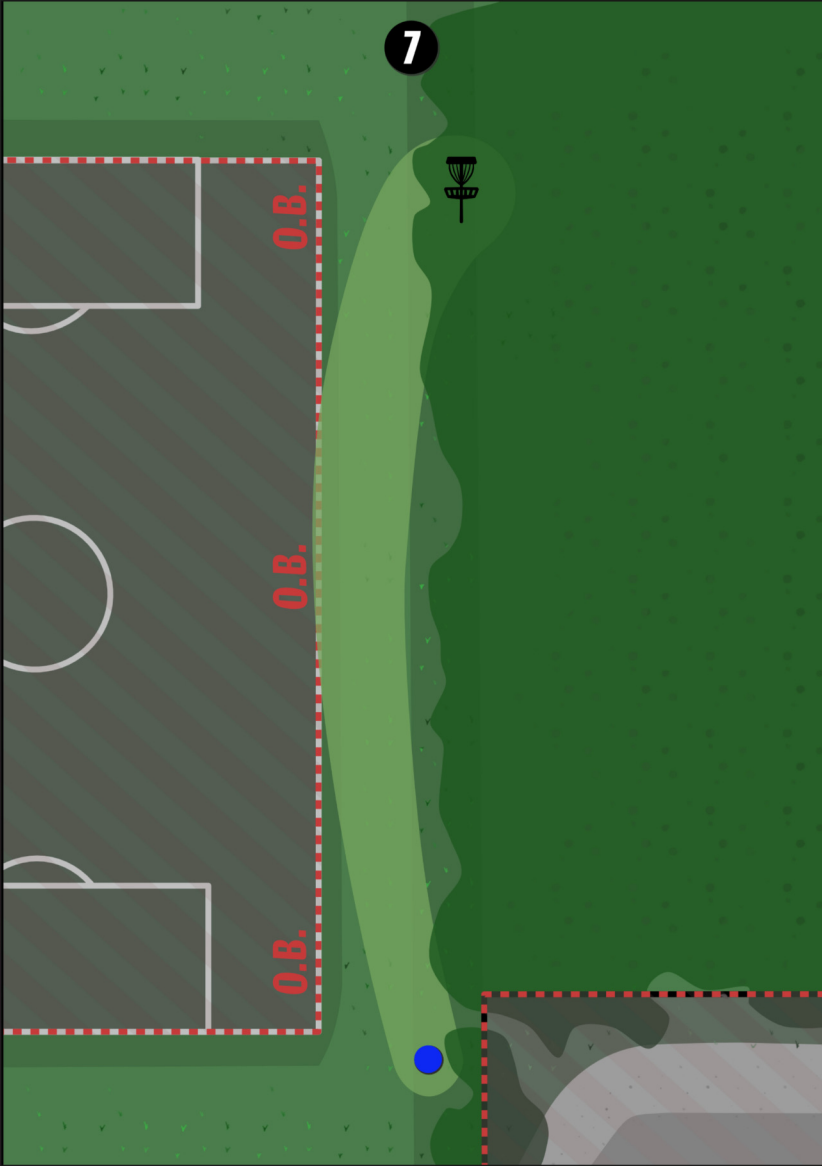

**HOLE 6 • PAR 3 • 105 M**



7

- the football field is out of bounds as marked
- everything beyond the fence on the right and behind the basket is OB

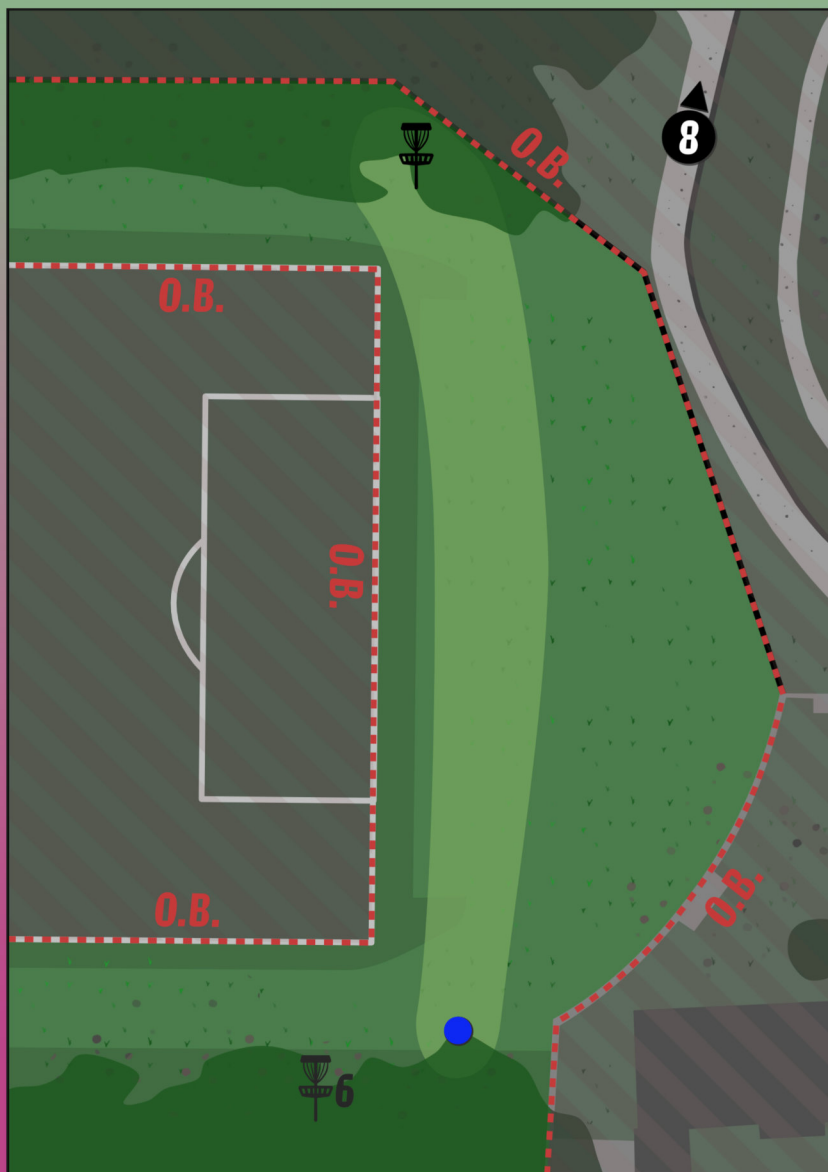

**HOLE**  
**7**  
•  
**PAR**  
**3**  
•  
**90**  
**M**

# 8

- everything beyond the fence separating the football from the fairway is OB
- the OB line is marked by the fairway facing side of the fence
- the fenced in enclosure on the left is OB
- everything beyond the fence marking the property line is OB

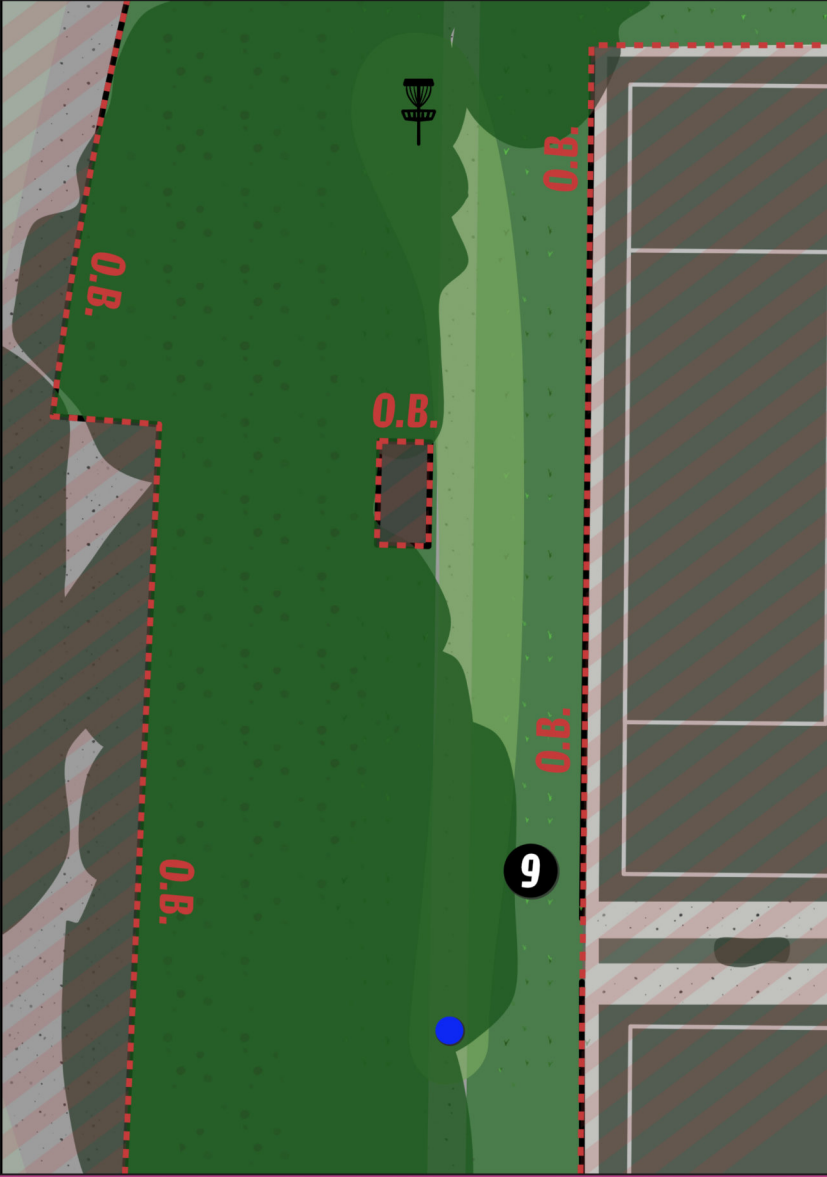

**HOLE 8 • PAR 3 • 75 M**



9

- everything beyond the fence separating the football field from the fairway is OB
- the OB line past the fence around the corner in the direction of the basket is marked by the football field markings
- everything beyond the property line on the right as marked by the fence is OB

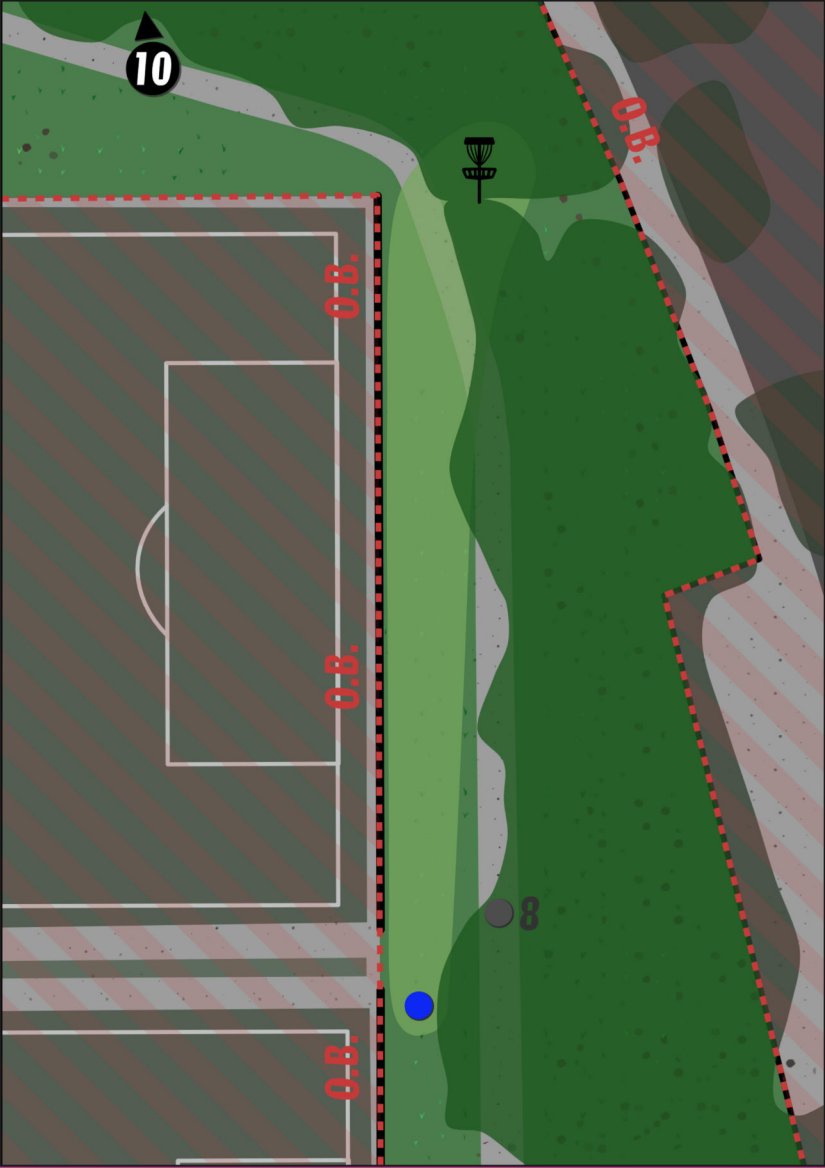

**HOLE 9 • PAR 3 • 80 M**



→ everything beyond the fence marking the property line is 0B





**HOLE**  
**10**  
•  
**PAR**  
**3**  
•  
**75**  
**M**



- everything beyond the concrete wall surrounding the oval of the fairway is OB
- the OB line is marked by the fairway facing side of the wall

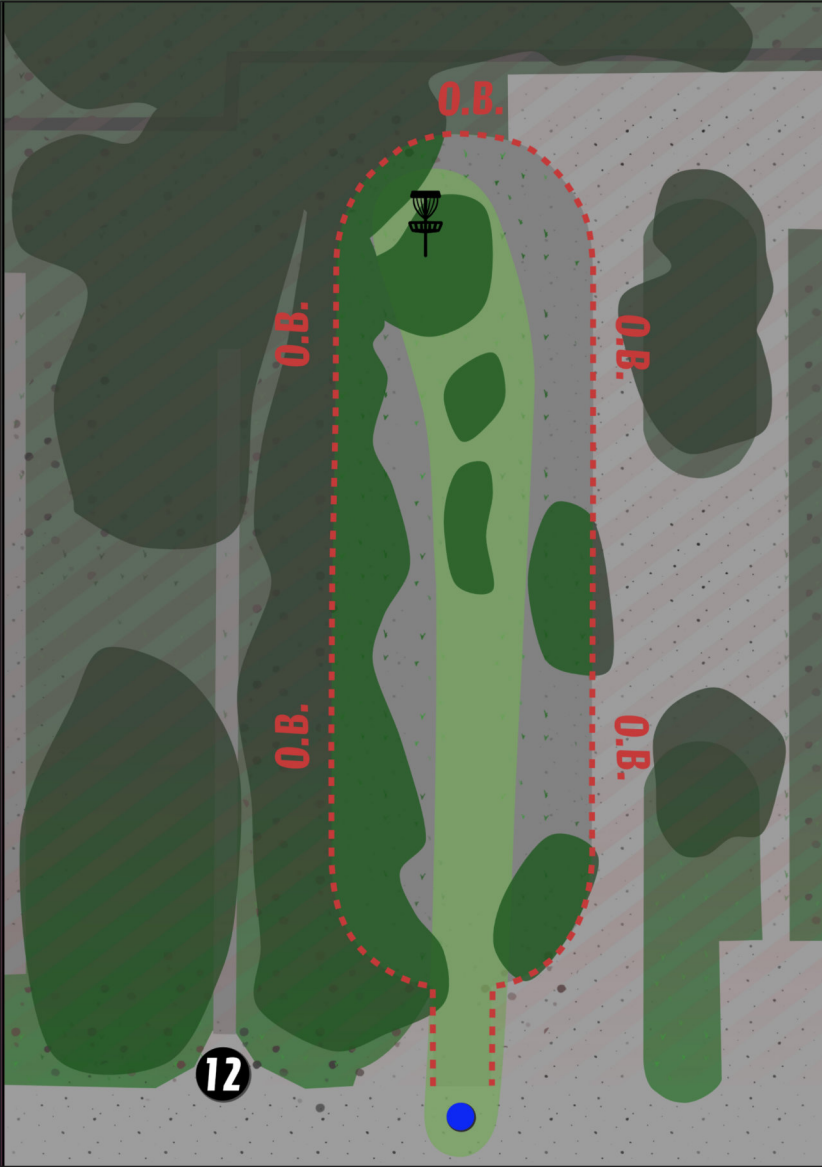

**HOLE**  
**11** • **PAR**  
**3** • **75**  
**M**



12

- everything beyond the concrete wall separating hole 11 & 12 on the right is OB
- the OB line is marked by the fairway facing side of the wall

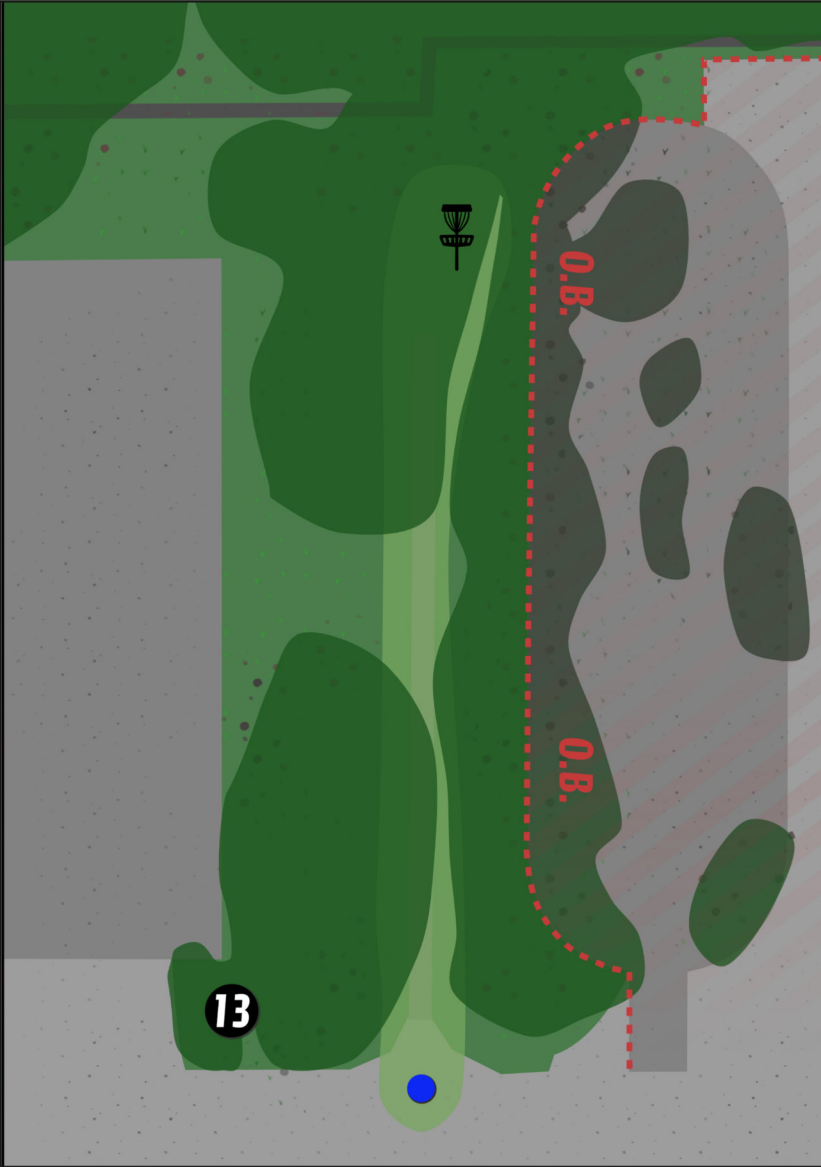

**HOLE**  
**12** • **PAR**  
**3** • **70**  
**M**

13

- the area directly below the heating pipe behind the basket is designated as a relief area and relief may be taken towards the basket according to OB rules but without a penalty

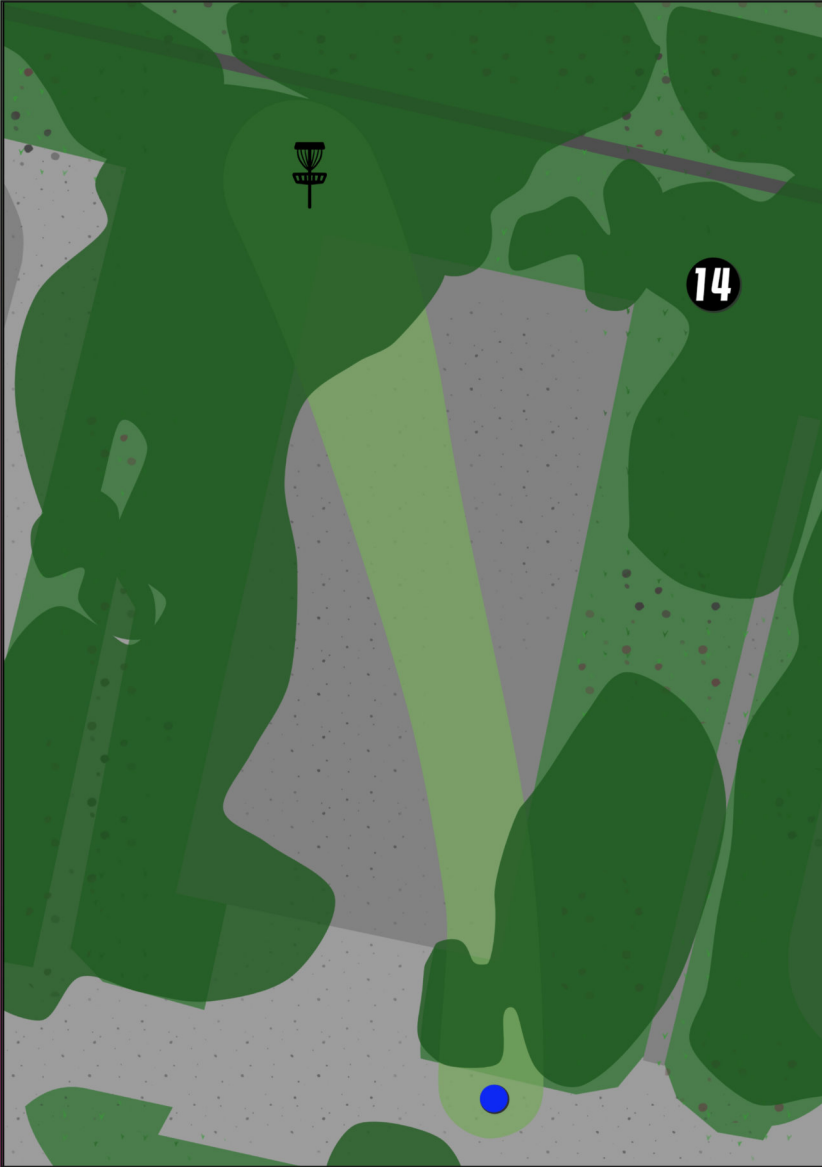

**H  
O  
L  
E**

**13**

**•**

**P  
A  
R**

**3**

**•**

**80  
M**



14

- the path beyond the basket and the main path are OB
- the OB line is the line of the path facing side of the curb





**H  
O  
L  
E**

**14**



**P  
A  
R**

**3**



**65  
M**

# 15

- the inner concrete oval is played as a hazard, a disc that lands inside is played from where it lands but the player receives a penalty stroke
- the border of the hazard is marked by the inside edge of the concrete wall
- the area directly below the heating pipe behind the basket is designated as a relief area and relief may be taken towards the basket according to OB rules but without a penalty

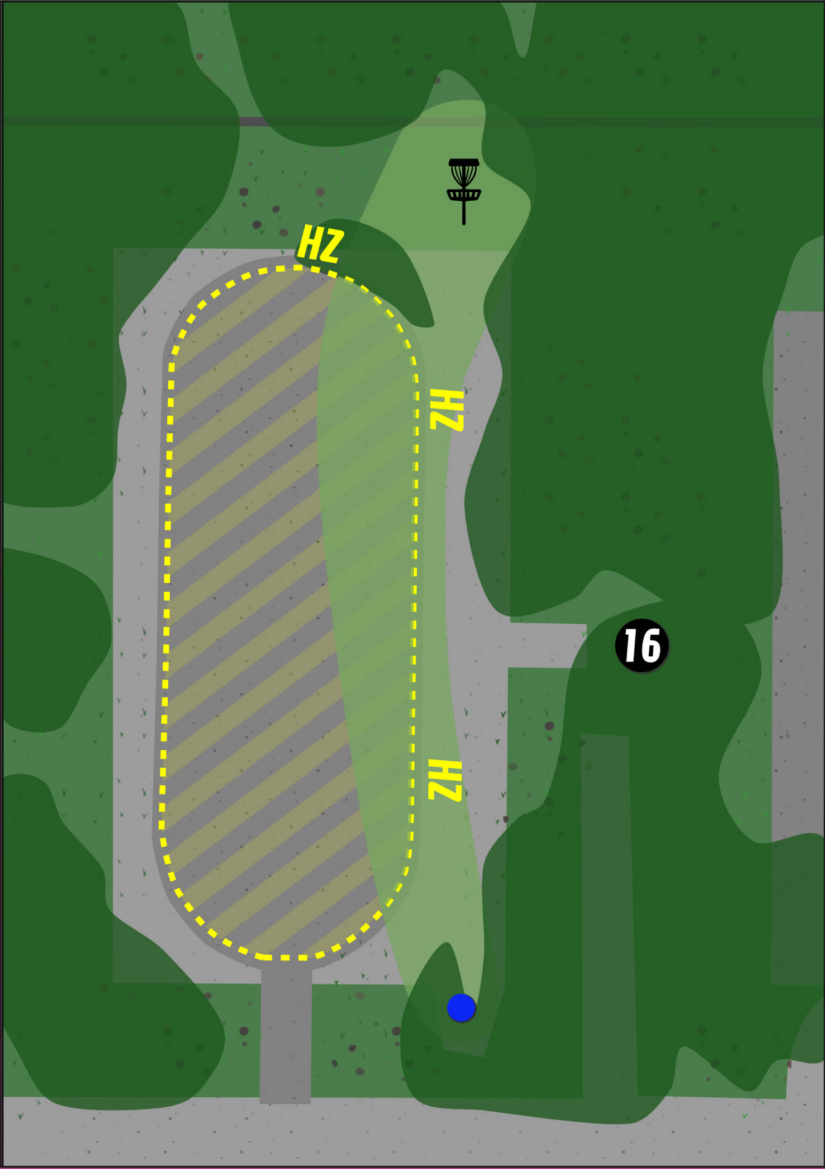

**HOLE**  
**15** • **PAR**  
**3** • **70 M**

# 16

- the hole is played as an island, the OB is as follows: the path behind the basket and beyond is OB, the line on the left side of the tee of 17 marks the OB on the right, the main path marks the OB on the left, the outside of the concrete wall pointing towards the basket and the adjoining ramp mark the OB towards the tee
- any disc that does not land in bounds from the tee moves to the drop zone which is marked on the concrete wall on the island side, for throws that go OB from the dz or island normal OB rules apply

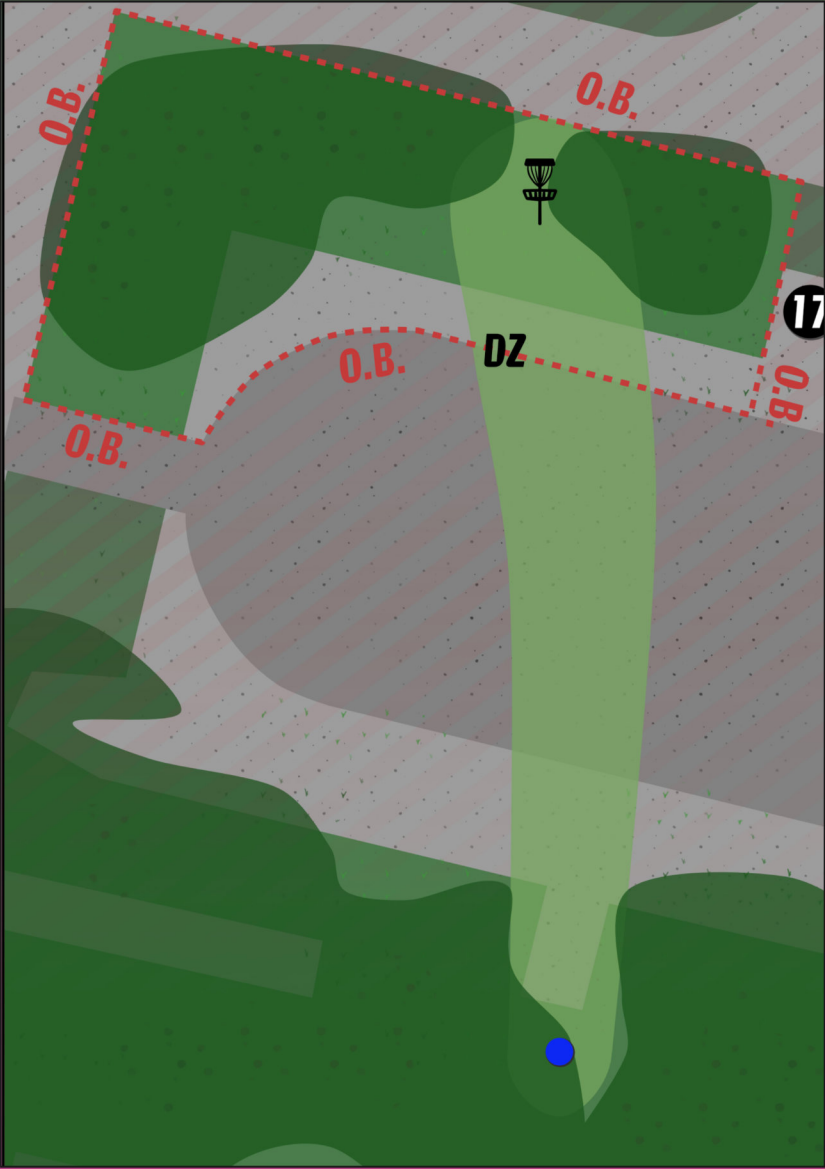

**HOLE**  
**16** • **PAR**  
**3** • **50 M**

# 17

- the roofs of all adjoining buildings are considered out of bounds
- players can take relief according to out of bounds rules without a penalty from the walls of the buildings surrounding the fairway
- everything beyond the property line as marked by the fence is out of bounds

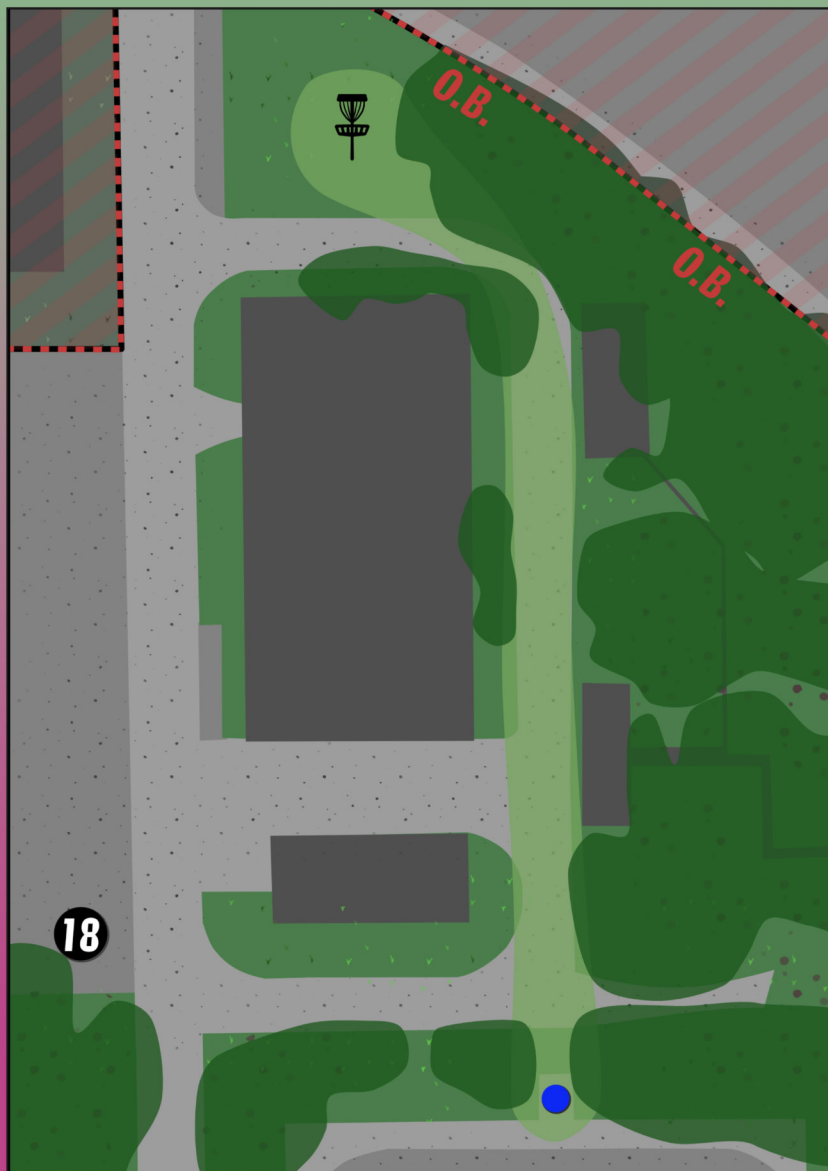

**H  
O  
L  
E**  
**17**  
•  
**P  
A  
R**  
**4**  
•  
**125**  
**M**



18

→ the concrete area to the left of  
the fairway behind the tree  
line is OB



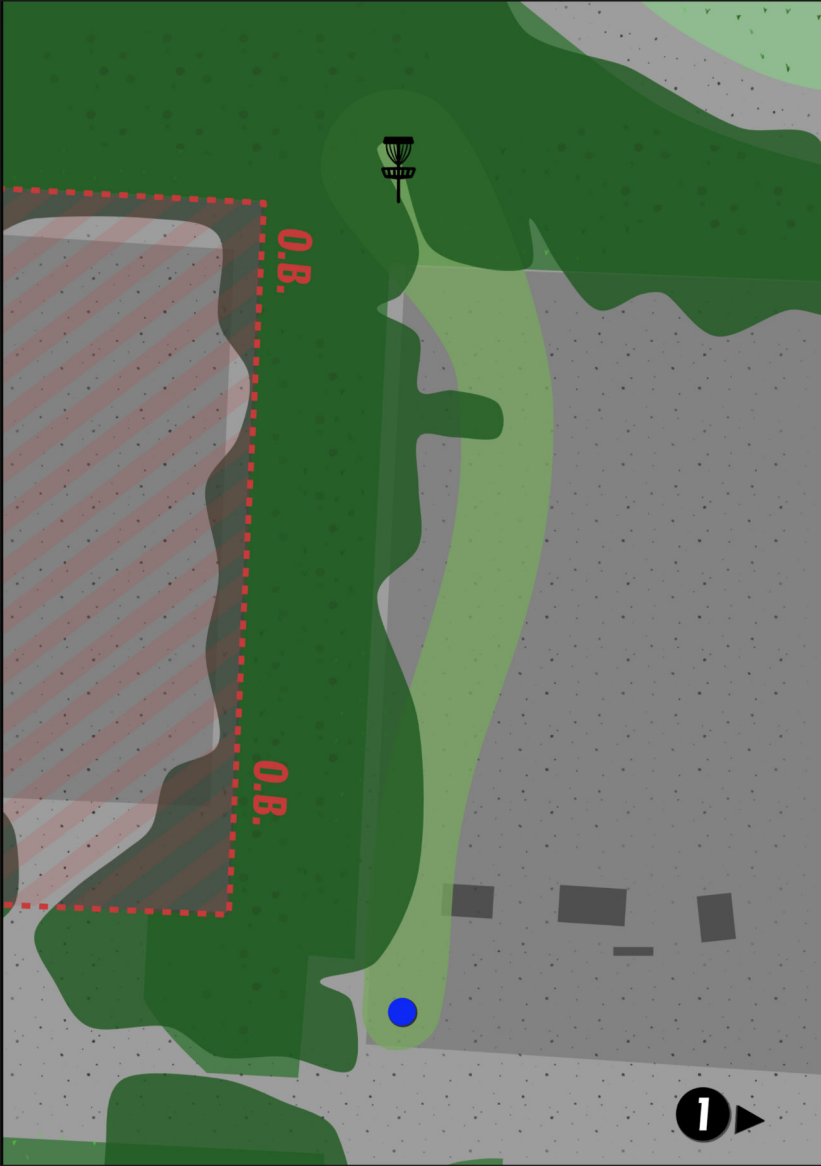

**H  
O  
L  
E**

**18**



**P  
A  
R**

**3**



**85  
M**

Special Thanks to the organizational team  
/ Besonderer Dank an das Orga-Team:

Andrew, Friederike, Hauke, Johannes,  
Oskar, Sebastian

...und natürlich an all die großartigen  
Helfer\*innen aus unserer Community!  
...and of course to all the amazing people  
from our community that helped!